

N88°23'14"E 263.81'

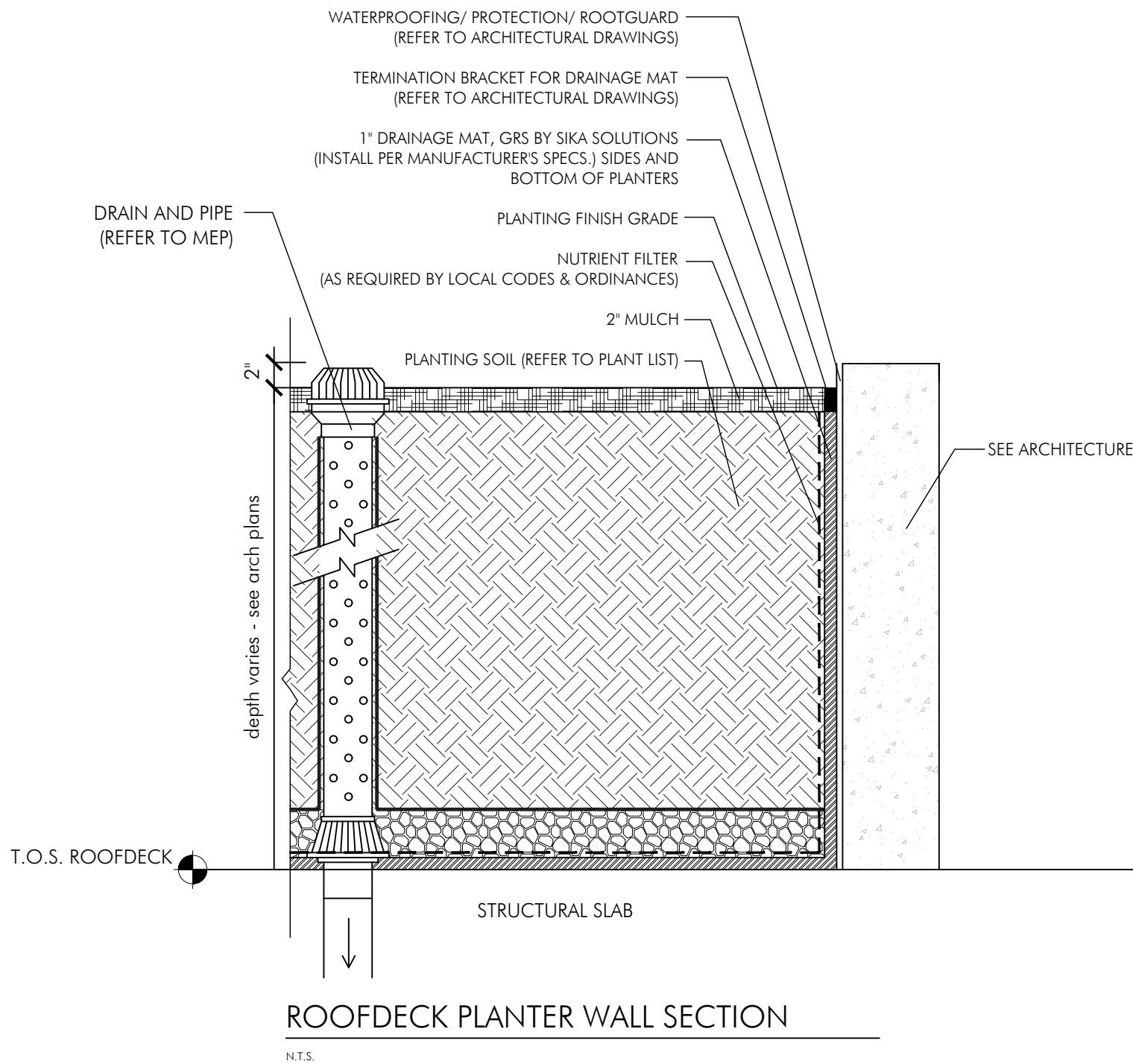

**absolute-idea.com**  
CANAL PARK  
3323 NE 163rd Street, Suite 200 North Miami Beach, FL 33160  
305.792.0015 305.931.0279 info@absolute-idea.com

SEAL  
KEN GARDNER  
FLA 1569  
TO THE BEST OF MY KNOWLEDGE, THE PLANS AND SPECIFICATIONS COMPLY WITH THE MINIMUM STANDARD REQUIREMENTS AND THE APPLICABLE PROFESSIONAL STANDARDS AS DETERMINED BY THE BOARD OF PROFESSIONALS WITHIN THE RELEVANT REGULATORY FRAMEWORK.

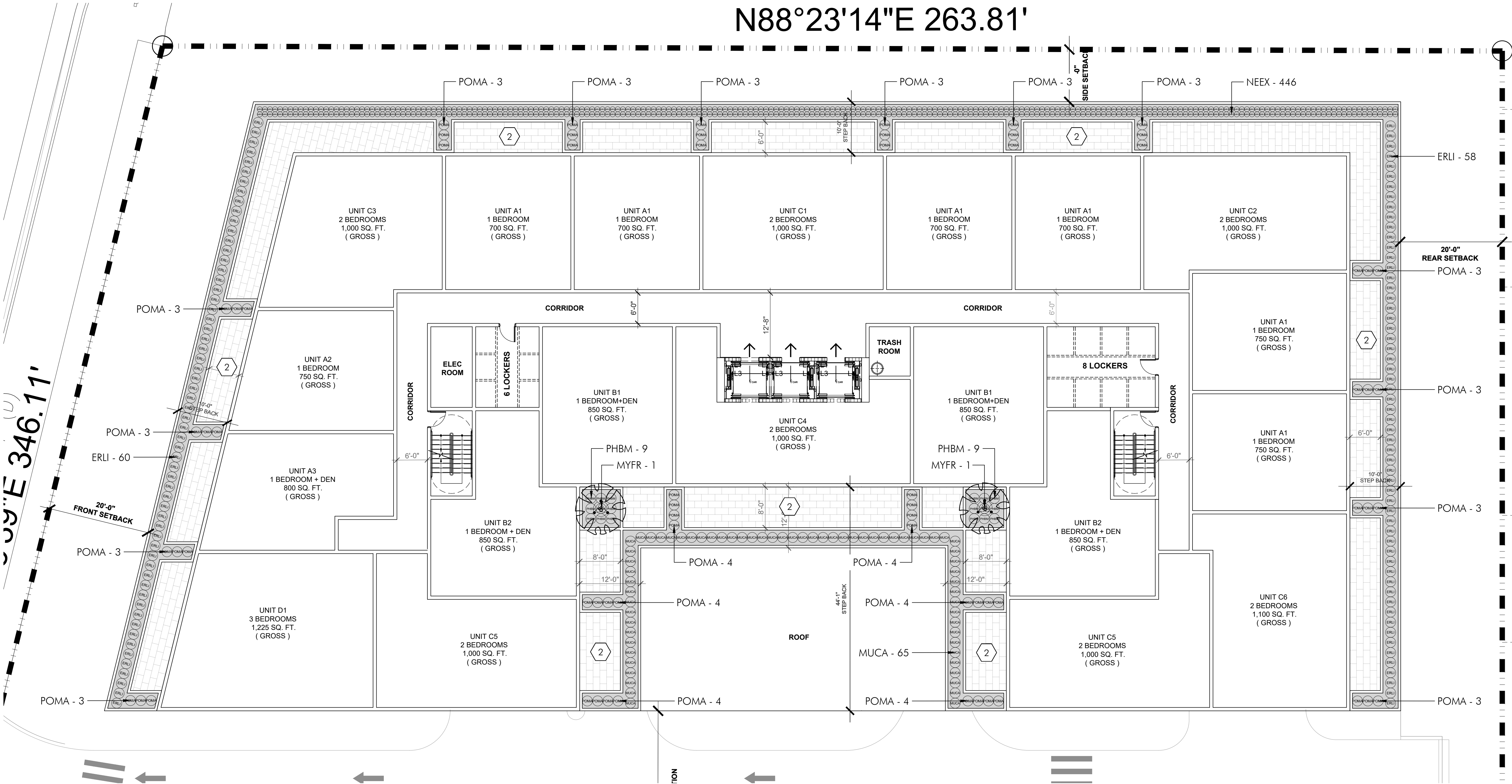
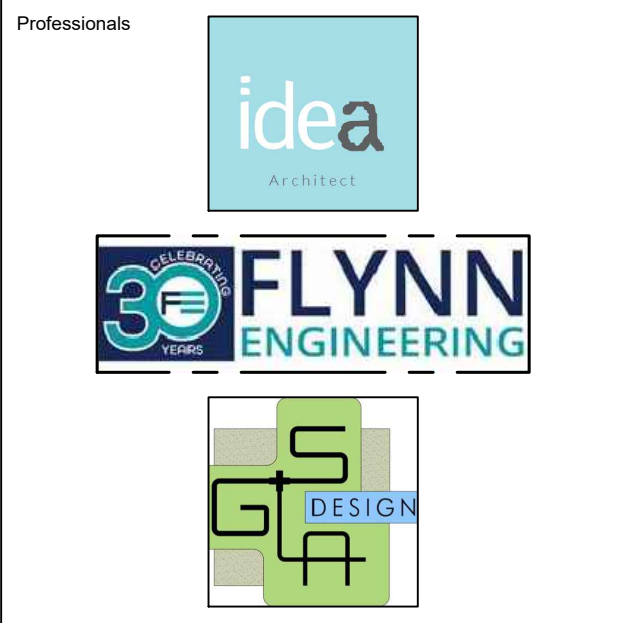

REV.	DATE	DESCRIPTION
01	XX-XX-2024	D.R.C. SUBMITTAL

ALL MEASUREMENTS MUST BE VERIFIED BEFORE BEGINNING THE WORKS. NO MEASUREMENTS ARE TO BE SCALED DIRECTLY FROM THIS DRAWING.

Key section  
**PROGRESS SET**

Client  
**VERA FUND**  
NICK POLYUSHKIN  
& YURI KHARITONENKOV  
TEL: 305.833.3303

Project  
**1600 S FEDERAL HIGHWAY  
(MIXED-USE PROJECT)**  
1600 SOUTH FEDERAL HIGHWAY,  
POMPANO BEACH, FL 33062

Title <b>PLANTING PLAN 4TH FLOOR</b>	
Drawn <b>GSLA</b>	Field <b>LANDSCAPE ARCH</b>
Verified <b>KG</b>	Scale <b>as shown</b>
Approved <b>KG</b>	Date <b>10-09-2024</b>
Project Manager <b>KG</b>	Dwg. no. <b>L-205</b>
Project <b>24-838</b>	

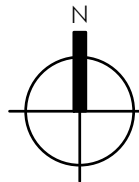

PLANTING PLAN - 4TH FLOOR

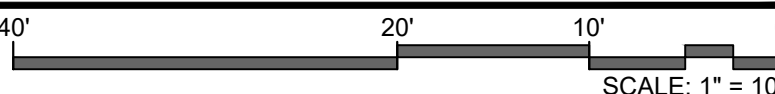

**DRC**

PZ24-12000027

04/16/2025